

SITE DRAWINGS LEGEND:

REFER TO BARRET MAHONY CIVIL ENGINEERING DRAWINGS FOR ALL DRAINAGE/ ROAD INFORMATION.

SURVEY INFORMATION PROVIDED BY JONES ENGINEERING ON 23.4.2019.

PLEASE REFER TO THE PAUL HOCARTH COMPANY LANDSCAPE DRAWINGS FOR ALL INFORMATION ON EXISTING AND PROPOSED TREES, MATERIAL FINISHES AND LAYOUT. ANY REFERENCE TO TREES/ HARD OR SOFT LANDSCAPING IN THIS DRAWING ARE INDICATIVE ONLY.

- EXISTING BUILDING
- PLANNING APPLICATION SITE BOUNDARY
- PLANNING APPLICATION OWNERSHIP OF APPLICANT

ALL APARTMENT TYPES SHOULD BE READ IN CONJUNCTION WITH DRAWING NO.S P1601, P1602, P1603, P1604 AND HOUSING QUALITY

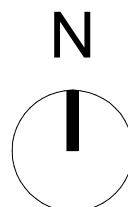

REV	DATE	DESCRIPTION	OKH	DRN
P2	26/11/2019	ISSUED FOR PLANNING APPROVAL	DB	OJ
P1	05/09/2019	ISSUED FOR PAC REQUEST	DB	OJ

STATUS CODE DESCRIPTION

ISSUED FOR PLANNING APPROVAL

CLIENT

Atlas GP Limited

PROJECT

Project Claremont

DRAWING

BLOCK B - ROOF PLAN

PROJECT NUMBER 950520	DATE 26/11/19
SCALE@ A1: As indicated	DRAWN/CHECKED: OJ/ DB

REVISION	DRAWING NUMBER	STATUS CODE:
P2	CLR-HJL-02-07-DR-A-1017B	A1

Henry J Lyons

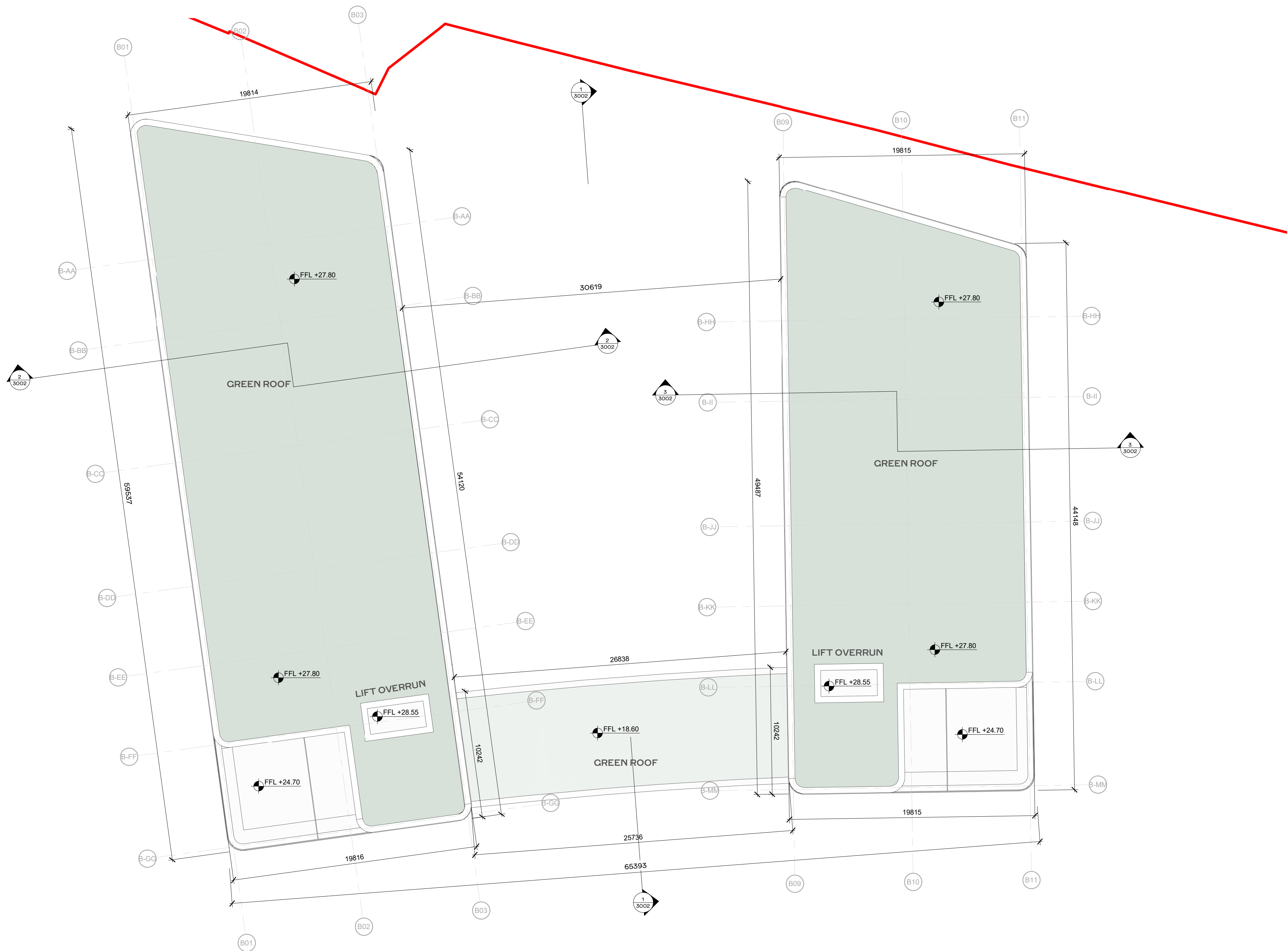

1 ZONE 02 - BLOCK B - ROOF PLAN
1:200